

## K6B INTERPHONE

### K6B IP-4TU MANUAL FOR OPERATION AND INSTALLATION

- Paging and call function with door phone
- Call function with Lobby Phone and Door open function
- Guard Office paging and calling function
- Internal call function between in-house intercoms

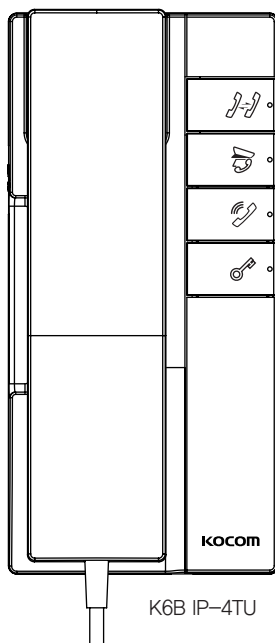

Thank you very much  
for purchasing KOCOM  
Interphone,  
please read this manual  
thoroughly to ensure  
correct usage,  
before operation



# Table of Contents

Cautions for Safety .....	3~4
Product Configuration .....	5
Product Specifications .....	5
How to Install .....	6
Name and Functions of Each Part .....	6
External Connection Diagrams .....	7
Method of use .....	8~9
Method of use of Lobby phone .....	10
Setting by installer .....	11

# Cautions for Safety

For safe use, please stick to the following cautions.

- Please save this manual after reading these instructions carefully.
- Read and understand all instructions to set up rightly.
- This Cautions for Safety may include items that are not contained in specifications of the product that consumer purchases.
- If you need assistance with the set-up or operation, please contact with A/S center.

## The important marks in the manual.

To help our customers to understand this manual, to prevent any personal injury or property damage, some marks are used in the manual. The marks and the drawing signs are below. Please understand the marks before reading the manual.

## The meaning of the drawing signs.



Sign to show what not to do.



Mishandling the device with ignoring this sign may result in serious injury or death.



Mishandling the device with ignoring this sign may result physical injury or material damage.



Sign to tell you that you should follow the instructions.



Sign to tell you that you need more attention including (high voltages, electric shock, danger, warning)



Sign to tell you that you can't disassemble this unit.



Sign to tell you that you must unplug the unit.



## Caution

### ▶ Cautions for set-up



- The law limits distributing the power lines to an authorized person from government. The work from an unauthorized person cause fire or electric shock.
- Place this unit securely on a stable surface. Serious damage and/or injury may result if the unit falls.
- Do not set up this unit near the leaking place because it may expose you to dangerous voltages or other risks.
- Even if your product is water proof, do not install it slanted place of water leakage, which can a short circuit.
- Fix the product on the wall safely according to the installation guideline to prevent any damage or injury.
- Don't put any stuff in 30cm around the monitor, not to block the air hole.



- The work of distributing wires needs skills and experiences. So please, for assistance, contact your dealer or call service center.
- The communication lines should be built in being distant from the power source. This may result in the risk of fire, electric shock and communication disorder.
- Setting the communication lines in a high humid place such as outside without any protection from rain causes the communication disorder.
- Keep the hook at the wall-mounted device safe. The hook may cause the physical injury.
- Think about the thickness and quality of wall material. The unqualified material may make the device fall.



- Set the device of the wall-mounted type not to fall. Falling from an earthquake causes personal injury.

### ▶ Cautions for Repairs and Maintenance



- Keep the inside of the device clean. Having the dust inside without any cleaning for a long time causes the fire. If necessary, contact your dealer or service center to get cleaning service.



- Unplug this device when you want to check the inside. If there is no plug, please, turn off the circuit breaker.
- Unplug this device when you try to move it to another place.
- If the electric line is connected inside of the unit, please contact your dealer or service center.



- Do not use liquid or aerosol cleaners. Use a damp cloth for cleaning.



## Warning

### ▶ Warnings for Usage



- Do not install this unit near the water and dust, for example, in a bathroom or near the washing machine. It caused fire and electric shock.
- Do not install this unit near the fire, for example, near kitchen sink, heater or the like.
- Do not install near the noxious gas such as Hydrogen Sulfide, metal power and the like.
- Do not install near the water and chemicals.
- Do not give any damage, break and modify the plug. Overloading, heating, pulling causes the damage.
- Do not place the plug near the heater. The damaged code causes fire and electric shock. Do not pull the power code when unplugging.
- The damaged code causes fire and electric shock. Must pull with plug. Do not touch with wet hands. It causes the electric shock.
- Do not use any other voltage, except the marked regular voltage.
- Do not use the power terminal at the units to other electric device except the designed device.
- Do not install the units at the leaking place if it doesn't have any waterproof mark. Do not install the unit when the power is on.
- Install the circuit breaker after checking the safety such as electric shock and leakage. Turn off the power before you install or A/S



- Check the suitability of the lines for installing when you use the exiting lines.
- Do the wiring work by using the designed material.
- Connect the electric wire with the designed ways and ground.
- Do not connect with any other devices except the designed devices to compose the system.



- Unplug electric wire and communication lines from the units before moving to another place.

## ⬢ Cautions for Use

- This unit is not designed for security purpose.
- Do not handle the unit with the wet hands.
- Do not place a pot with water or a small metal material on the Units.
- Do not cover the ventilating opening or put any metal material in the units.
- During thunderstorms, avoid using this unit. There may be a remote risk of an electric shock from lightning.
- Do not modify the unit.
- Open the main gate after checking ID if the image and sound system do not work, Call A/S



- Do not disassemble the back and cabinet cover.

## ⬢ Cautions for Abnormality



- Change the damaged electric code.
- Unplug this unit from plug socket and refer servicing to an authorized service center when the following conditions occur:
  - If liquid has been spilled into the unit.
  - If the unit does not work normally by following the operating instructions.
  - If the unit exhibits a distinct change in performance.
  - If the unit has been dropped or physically damaged.
- The mains plug, as a disconnection device, shall remain readily accessible by the user.

# Caution

## ⬢ Safety Instructions, Warnings and Cautions of Each System

- Do not disassemble this unit at will as this device is composed by precision parts.
- Install the unit by following the set-up instructions of Kocom.
- Do not touch or insert any foreign substances, for example, sticker, magnetic, opener and the like.
- Make U-type at the end of wires as the rain can effect on the system by following the wires during the rainy season.

## ⬢ Videophone

- Separate the AC/DC lines with the hook of the wall-mounted type when installing.
- Connect the lines after peeling the wires properly.
- Do not distribute signal line with AC line.
- Use the designed driver to connect the lines to terminal.
- Do not clean the LCD with the damp cloth for cleaning. Use the only dry and soft cloth.
- Do not install the main gate monitor at the leaking place.

## ⬢ Must NOTE

- This product is designed as a home videophone and cannot use continuously like monitor camera.
- If there is temperature difference between inner part of camera and surrounding, dew condensation occurs on camera lens and may disturb image. If dew condensation is removed from camera lens, image quality recovers.
- White LED light examination range is narrower than camera shot range at night, so there is less amount of light at night than day. So it is difficult to see the face in low illumination condition due to noise increase on screen, but it is not from defect.
- Monitor screen (liquid crystal panel) is not in defect when some pixels always light or black out.
- Please install monitor and camera over 5cm away.
- Also, avoid installing at a place with too much noise, because too much noise around camera causes phone call inferiority.
- Do not place an object within 20cm in front of monitor. It causes phone call inferiority, especially because microphone is installed at the top of monitor.
- If strong light such as sunlight flows into camera module, screen saturation (or strange mark) and image shaking might occur.
- This is not a defect, so please do not install camera where a direct ray of light do not flow if possible.

## ⬢ Cautions

- In some cases there is occurrence of product destruction, malfunction, noise mixing and picture quality deterioration due to mixing of other tool's induced, voltage or thunder with communication wiring of monitor/camera, monitor/extended monitor.
- Do not wire with power line such as outdoor wiring or AC power, or phones and other tools.
- You cannot use it if you incorrectly wire the AC voltage between monitor/camera, monitor/extended monitor.
- Call the store or agency where you purchased this product and consult to solve the problem.
- Beware that unfixable damage might be caused due to authorizing AC voltage on communication wiring of monitor/camera, monitor/extended monitor.
- Do not ever disjoint this product. It may cause electrocution accident when touching high-voltage circuit inside this product.
- Outside power authorizing this product must be confirmed of product description and use rated voltage.
- Beware that if higher voltage is authorized, unfixable damage might be caused due to product destruction.
- Power must be connected to domestic voltage (product rated voltage) consent or interior wiring.
- If connected to other motive power or inverter-type power, product destruction, noise mixing, and picture distortion may occur.
- Do not drop this product. Glass is used for monitor and might break, or cause other circuit inferiority.
- In such case, immediately turn down the power switch, and call to consult agency or store in which this product was purchased.
- Keep away from any conditions where water splatters or falls. Do not place anything containing water like a vase on the product.
- If installed near transmission antenna such as broadcasting station, electric wave may mix and cause picture distortion or voice mixing.
- Avoid installing near tools with strong electromagnetic waves such as microwaves and cell phones, or it may cause picture distortion.
- Do not install monitor in places.
  - ① Above or around water heater, rice-cooker, heater
  - ② Place exposed to direct rays of the sun
  - ③ Place with temperature below 0°C such as cold store
  - ④ Place with high humidity such as bathroom, washroom, heated room
  - ⑤ Place with a lot of gas, dust, smoke
  - ⑥ Dangerous place with sprays of water or chemicals
- Do not wipe with insecticide, drugs or chemicals such as thinner and alcohol, or it may damage the surface of this product.
- Beware of occurrence of image quality deterioration or malfunction from cause of humidity due to penetration of chemicals or water into camera's urea resins.
- As in the picture, it prevents temperature difference of camera (outside) and monitor (inside), and removes dew condensation caused by humidity of camera window.
- Camera must be installed when wall cement is completely dry.
- When product is installed in winter below -5°C, wait for approximately 2 hours to connect. Dew formation in monitor and camera due to temperature difference inside and outside may cause product defect.
- Avoid installing monitor and camera in place directly exposed to heat or where gas noxiousness is highly occurring.
- In relation to Mechanical energy Source(MS), The device installation height should be mounted within 2m.

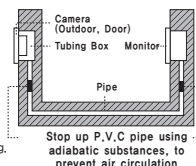

## Product configuration

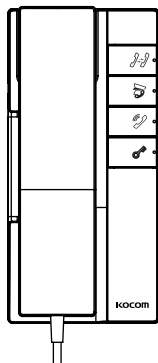

- Screws  
 4 x 25mm(27#)

- A Wall hanger frame

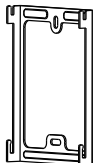

- 2PIN cabel for Door phone



- 8PIN cabel for K6B system



- 2PIN cabel for door opener (1ea)



## Specifications

Model No.	K6B IP-4TU
Power Source	AC 100~240 V~, 50/60 Hz
Power Consumption	1.2W(Stand by), 4W(In load)
Operating Temperature	0°C ~ +50°C
Communication System	Balance Type, Handset Type
Signal Sound	Chime(Front door / Guard / Lobby)
Wiring	<ul style="list-style-type: none"> <li>· K6B SYSTEM : 6 Wire (Polarized) (DATA_A / DATA_B / No Connection / VOICE2+ / VOICE2- / VOICE3+ / VOICE3-)</li> <li>· DOOR PHONE : 2 Wire (Non-Polarized) (GND / AUDIO)</li> <li>· INTERNAL CALL : With K6B System Port, Pin 3,4 (INTERCOM1+, INTERCOM1-) Shall be used for only interphone extention purpose. (Between Main interphones and Sub interphones.</li> </ul>
Range	<ul style="list-style-type: none"> <li>· Lobbyphone to KU-P100INT : 50m</li> <li>· KU-P100INT to GP-70K : 100m</li> <li>· KU-P100INT to KU-F100 : 300m</li> <li>· KU-F100 to KD-8P : 50m</li> <li>· KD-8P to Interphone : 50m</li> <li>· KU-P100INT and Last KU-P100INT : 800m</li> <li>· Interphone to Doorphone : 50m</li> </ul>
Dimension(mm)	97.3(W) x 202.1(H) x 53.5(D)mm

## How to install

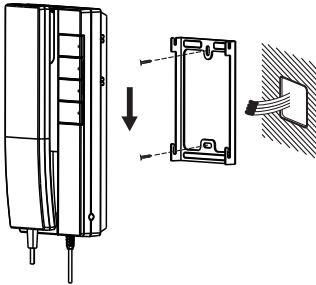

- 1) Affix a wall-hung metal piece to the wall and fasten it with a screw.
- 2) Connect the wire, match the body to the groove of the wall-hung bracket and then fix it by pulling it down.
- 3) Be sure to close the wire after connection.

## Explanation and function of each part

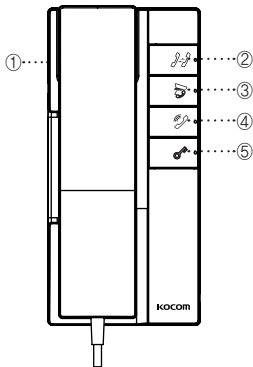

- ① 3-tier volume switch (side) : Adjusting volume [High / Medium / OFF]
- ② Extension button : Used for paging an extension or receiving paging from an extension.
- ③ Guard button : Used for paging Guard Office or receiving paging from Guard Office.
- ④ Call button : Used for receiving paging from Lobby Phone while talking over door phone.
- ⑤ Door Open button : Press the button while talking over Lobby Phone to have the door opened where the switch is installed.

## Specification of wire connection

- K6B main wiring is 6-line polar wiring.
  - Wire connection with door phone is 2-line non-polar wiring.
- (Note: There may be a difference in the sound level of call if wiring is not done as in the manual.)

## Function specification of the product

- Paging and call function with door phone
- Call function with Lobby Phone : Can talk over the phone for 3 minutes after the paging sound rings.  
(Press the switch button while talking over Lobby Phone to have Lobby door opened where the switch is installed.)
- Guard Office paging and calling function  
(Press the Guard button of the interphone to page guard and talk over the phone for up to 3 minutes.)

### External connection diagram

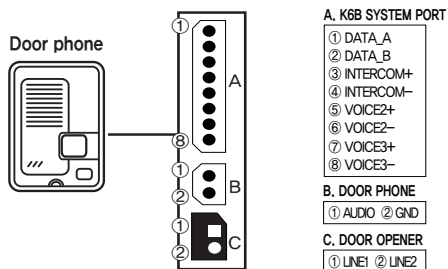

### Precautions for wire connection

- Connect wire with care as the device will not operate or there will be a problem with calling if wire connection is not done correctly.
- Loosen the screw when connecting wiring cord with the terminal and fix it by putting the end part of the cord at the bottom of the screw.
- When fixing wiring cord, fix it with a stapler, etc. to prevent damage to the cord.
- Be careful with disconnection and short circuit when using the existing wiring.

※ When connecting K6B system, do not connect No. 3 and No. 4 pins (6-line connection), and connect No. 3 and No. 4 pins for extension call when the interphone of the household is connected. (8-line connection between household interphones)

### ■ Entire Connection Diagram

※ This interphone can be connected up to 3 interphones per unit including the main and sub units.

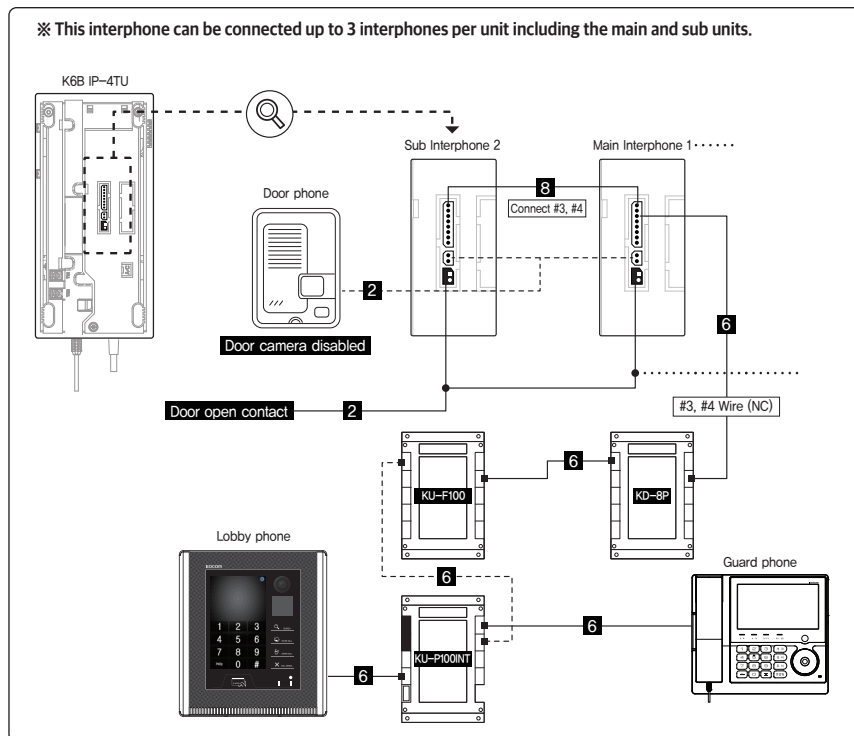

## Method of use

### ■ Door paging and call (Interphone cannot be linked to door camera)

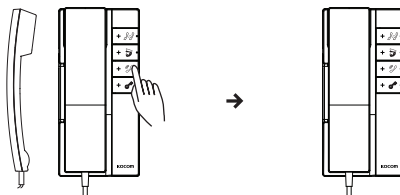

- ① When paging is done from the door, door chime sound is heard and the call LED blinks.
- ② Pick up the handset to talk. (Call LED is turned on.)
- ③ Put down the handset on the device after calling to end the call.
- ④ Can also talk by picking up the handset and pressing Call button [ ].

### ■ When paging is done from Lobby phone

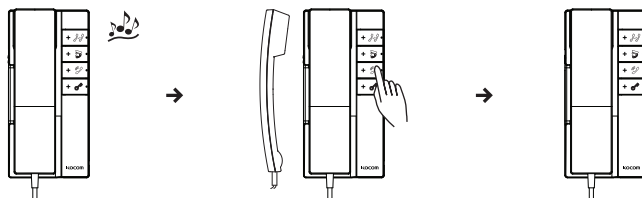



- ① Page the household device from the Lobby Phone while waiting, and a paging sound (tone sound) rings in the household for 30 seconds.
- ② Paging sound is output through the speaker of the handset and the call LED blinks.
- ③ Pick up the handset to talk over Lobby Phone automatically. (Calling time : 3 minutes)
- ④ To open the switch while talking over Lobby Phone, press Door Open button [ ] and the switch will operate automatically.
- ⑤ Put down the handset to end. (However, paging cannot be done to Lobby Phone.)

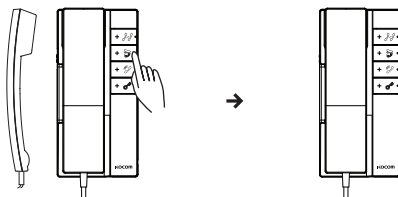

## Method of use

### ■ When paging is done from the household to Guard office



- ① Pick up the handset and press Guard button [  ] to send paging to Guard Phone. (Paging sound : 30 seconds)
- ② Calling state will last if the Guard Phone is responding to the call. (Calling time : 3 minutes)  
(LED is ON during the call and OFF after the call.)

### ■ When paging is done from Guard office to the household

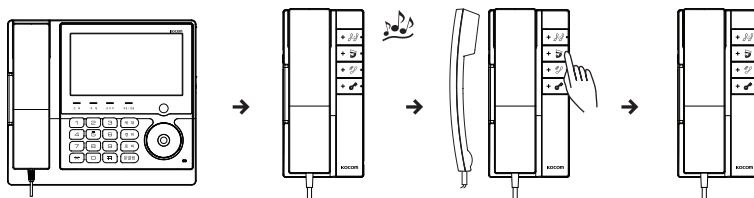

- ① If paging is done from Guard Phone, a paging tone sound rings at the handset (Paging sound : 30 seconds) and Guard LED blinks.
- ② Calling state will last while the handset is picked up. (Calling time : 3 minutes)  
(LED is ON during the call and OFF after the call.)

### ■ When paging is done from the household to an extension

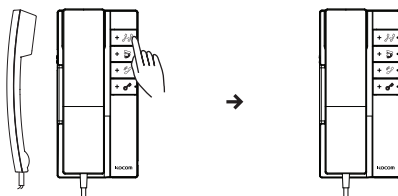

- ① Pick up the handset and press Extension button [  ] to send paging to another interphone. (Paging sound : 30 seconds)
- ② Calling state will last if another interphone is responding to the call. (Calling time : 3 minutes)  
(LED is ON during the call and OFF after the call.)

※ It is impossible to link video phone to K6B IP-4TU extension paging

## Method of use of Lobby phone (K6B LP-70D)

### ■ Linked Lobby phone



[K6B LP-70D]

### ■ Paging household

Household No. ▶



▲ Enter household No. (Flat No.)

▲ Press Page Household button (📞).

· To page Flat #1001, press (1) (0) (0) (1) (📞) buttons consecutively.

· If a wrong household No. was pressed or to cancel Page, use (✕) button.

### ■ Setting household password

While the household is paged and on the phone,



· To change entrance password of Flat #1001,

(1) (0) (0) (1) (📞) Press buttons consecutively and, if the household is on the phone,

(#) (#) (0) (0) (#) Press buttons and, wait for 10 seconds and then enter the desired 4-digit password and

(#) Press # button to complete setting of password and hang up.

## Setting by installer

### ■ Interphone type setting (using 2 or more sets with the same household No.)



· Single : When only 1 set of interphone is used



· Main : When 2 or more sets of interphone are used  
(Only one of the several sets should be set as Main,)



· Sub : When 2 or more sets of interphone are used  
(All interphones except the 1 set of Main should be set as Sub.)



· Reserve : Not used

### ■ Household ID setting (How to set household ID in Lobby Phone / Guard Phone)

#### 〈How to set interphone ID in Lobby Phone〉

- ① Press Door Open button for 4 seconds. While the handset is put on the interphone.  
The setting sound rings and the extension LED and Guard LED blink once.
- ② The extension LED and Guard LED blink. Within 5 seconds, press Guard button for 2 seconds.  
The setting sound rings and Guard LED blinks.
- ③ Within 3 minutes after Guard LED blinks, page the household with the household No. to be set in Lobby Phone.  
If the lobby page melody rings in interphone, the Interphone ID is saved with the [Building No.+Household Flat No.]  
paged from Lobby Phone.

#### 〈How to set interphone ID in Guard Phone〉

- ① Page from household to Guard.
- ② Guard office responds to it and connect call.
- ③ Press manager button in Guard phone and then enter the desired [Building No.+Household Flat No.].
- ④ Press # (Confirm) button to save Interphone ID.

Even if Interphone type setting is Main, Sub, ID setting is the same.

## Warranty

► To receive after service, have the following ready before you contact our branches.

1. Name of the product.
2. Model number of the product.
3. The area of problem.
4. Phone number and address at which you can be contacted.

## Warranty Card

PRODUCT	
MODEL	K6B IP-4TU
DATE PURCHASED	
WARRANTY PERIOD	
AGENCY ADDRESS	

► KOCOM Warranties the original purchaser of this product as follows.

- 1) This product is produced under strict quality control and inspection procedures.
- 2) If this product breaks down during proper use as a result of product defect, KOCOM will repair it within one year from date of purchase free of charge.
- 3) The following cases will be subject to charge, even during warranty period:
  - a. Breakdown during transport, or through careless treatment, by consumer.
  - b. Breakdown cause by unauthorized repair, or system modification.
  - c. Breakdown caused by natural disaster or power disorder.

**KOCOM**  
KOREA COMMUNICATIONS CO.,LTD



www.kocom.com  
E-mail : global@kocom.co.kr

This manual is based on the date as shown in the right and specifications are subject to change without notice for quality improvement

K6B IP-4TU

W1109