

4Wire Interphone Manual

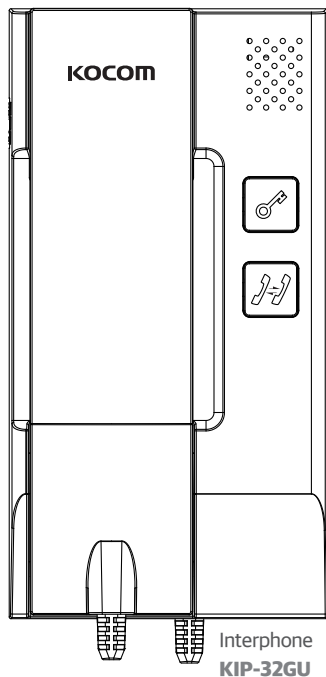

[KIP-32GU]

Manual for Operation and Installation



- Audio call with door camera through monitor
- Door open function
- Communicate with another monitor or interphone
- No need additional power adaptor,
powered by indoor monitor

KOCOM CO.,LTD.

Thank you very much for purchasing
KOCOM product, please read
this manual thoroughly to ensure
correct usage, before operation



Scan **QR** for
video instructions



Cautions for safety







For safe use, please stick to the following cautions.

- Please, save this manual after reading these instructions carefully.
- Read and understand all instructions to set up rightly.
- This Cautions for Safety may include items that are not contained in specifications of the product that consumer purchases.
- If you need assistance with the set-up or operation, please contact with A/S center.

The important marks in the manual.

To help our customers to understand this manual, to prevent any personal injury or property damage, some marks are used in the manual. The marks and the drawing signs are below. Please, understand the marks before reading the manual.



The meaning of the drawing signs.

 Sign to show what not to do.	 Mishandling the device with ignoring this sign may result in serious injury or death.
 Sing to tell you that you need more attention including high voltages, electric shock, danger, warning.	
 Mishandling the device with ignoring this sign may result physical injury or material damage.	
 Sign to tell you that you should follow the instructions.	
 Sign to tell you that you can't disassemble this unit.	 Sign to tell you that you must unplug the unit.

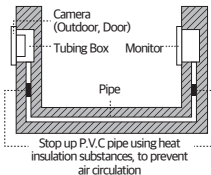

Cautions

Cautions for set-up

- The law limits distributing the power lines to an authorized person from government. The work from an unauthorrized person cause fire or electric shock.
 - Even if your product is water proof, do not install it slanted place of water leakage, which can a short circuit.
 - Avoid installing near tools with strong electromagnetic waves such as microwaves and cell phones, or it may cause communication disruption.
 -  · Do not install monitor in following places.
 - ① Above or near the heat sources such as water heater, rice cooker and/or heater
 - ② Place exposed to direct rays of the sun
 - ③ Place with temperature below 0°C such as cold storage
 - ④ Place with high humidity such as bathroom, washroom, heated room
 - ⑤ Place with a lot of gas, dust, smoke
 - ⑥ Dangerous place with sprays of water or chemicals
 - Beware of communication disruption or malfunction from penetration of chemical or water.
- 



Camera (Outdoor, Door)
Tubing Box
Monitor
Pipe
Stop up P.V.C pipe using heat insulation substances, to prevent air circulation
- The communication lines should be built in being distant from the power source. This may result in the risk of fire, electric shock and communication disruption.
 -  · Setting the communication lines in a high humid place such as outside without any protection from rain causes the communication disruption.
 - Keep the hook at the wall-mounted device safe. The hook may cause the physical injury.
 - Think about the thickness and quality of wall material. The unqualified material may make the device fall.
-  · Set the device of the wall-mounted type not to fall. Falling from an earthquake causes personal injury.

Cautions for Repairs and Maintenance



-  · Keep the inside of the device clean. Having the dust inside without any cleaning for a long time causes the fire. If necessary, contact your dealer or service center to get cleaning service.
- Unplug this device when you want to check the inside. If there is no plug, please, turn off the circuit breaker.
-  · Unplug this device when you try to move it to another place. If the electric line is connected inside of the unit, please contact your dealer or service center.

Warning

Warnings for Usage

- Do not give any damage, break and modify the plug. Overloading, heating, pulling causes the damage.
 - Do not use the power terminal at the units to other electric device except the designed device.
 - Do not install the unit when the power is on.
 -  · Install the circuit breaker after checking the safety such as electric shock and leakage. Turn off the power before you install or A/S
 - Power must be connected to domestic voltage (product rated voltage) plug socket or interior wiring.
 - Properly strip the wires before connecting them.
 - Do not run signal line together with AC power line.
-  · Connect the electric wire as designed and ground properly.

Cautions for Use

- This unit is not designed for security purpose.
 - Do not handle the unit with the wet hands.
 - Do not place a pot with water or a small metal material on the Units.
 -  · Do not cover the ventilating opening or put any metal material in the units.
 - During thunderstorms, avoid using this unit.
 - There may be a remote risk of an electric shock from lighting.
 - Do not modify the unit.
 - Open the main gate after checking ID if the image and sound system do not work. Call A/S
-  · Do not disassemble the back and cabinet cover.

Cautions for Abnormality

- Change the damaged electric cord.
- Unplug this unit from plug socket and refer servicing to an authorized service center when the following conditions occur.
-  · If liquid has been spilled into the unit.
- If the unit does not work normally by following the operating instructions.
- If the unit exhibits a distinct change in performance.
- If the unit has been dropped or physically damaged.



View the full version of Precautions ▲

Interphone_Installation

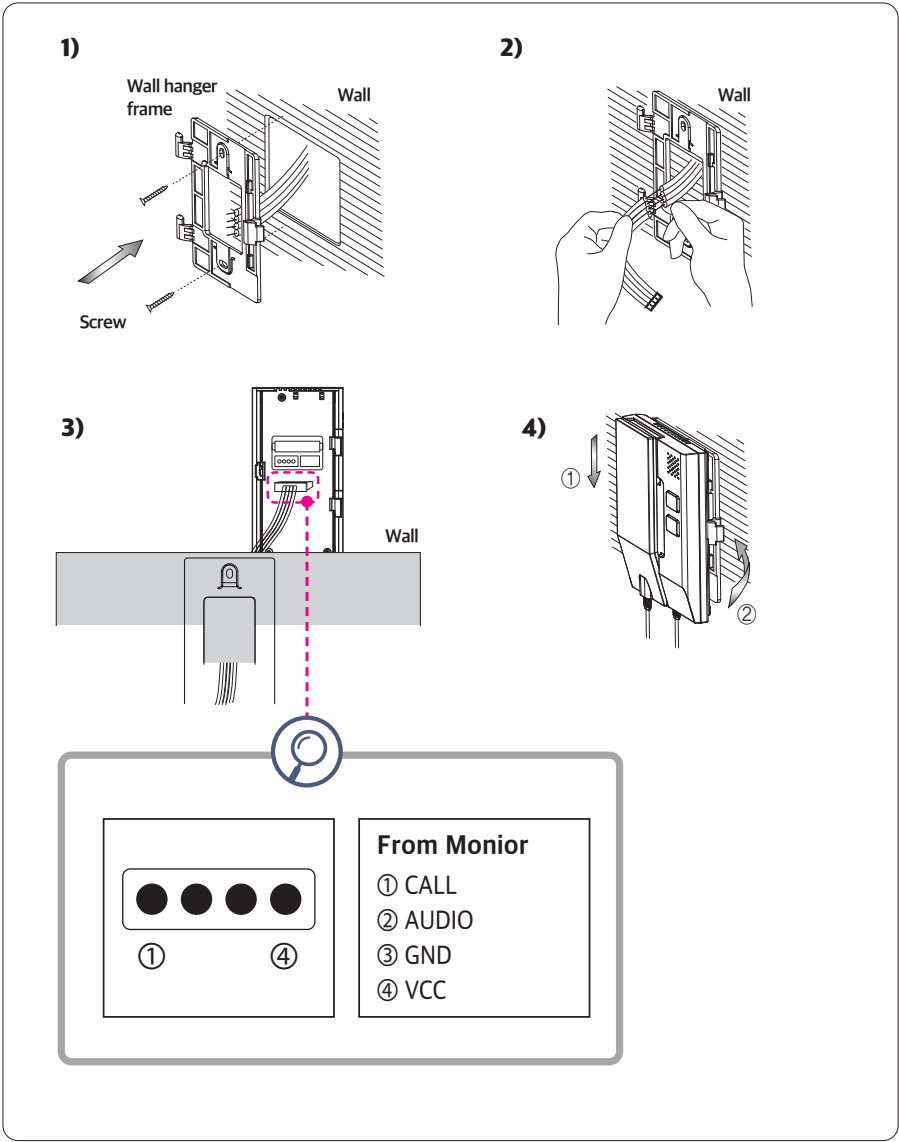

Interphone_Components of Product

■ KIP-32GU

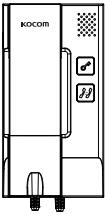

■ Wall hanger frame

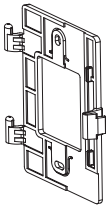

■ Wire



■ Screws

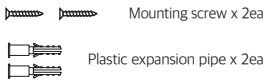

Interphone_Name of Each Part

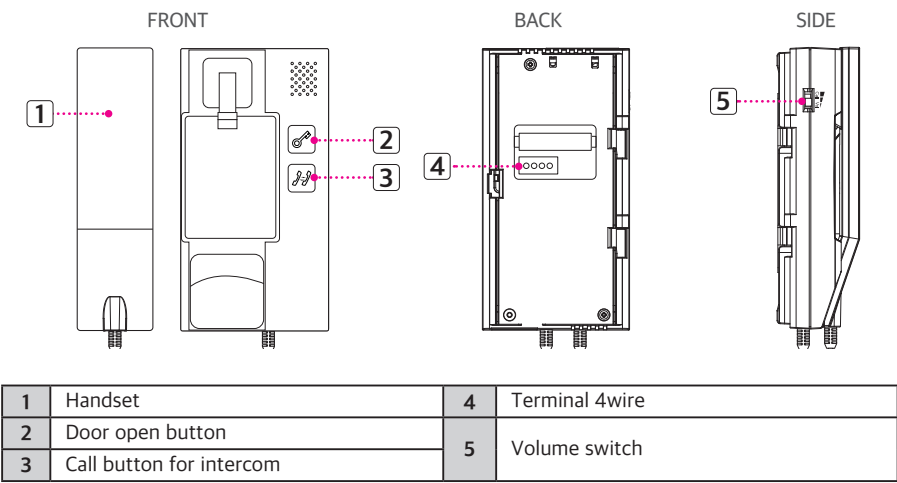

Product Specifications

Interphone	Model No.	KIP-32GU
	Power Source	DC 14V ±IV (Power from Monitor)
	Power Consumption	In load: 2.5W±20%
	Operating Temperature	0℃ ~ +40℃
	Mount Type	Surface mount
	Dimension	92(W) x 176(H) x 52(D) mm

Wiring Connection_Between Indoor station and door camera

■ Wiring diagram of between indoor station and Door camera

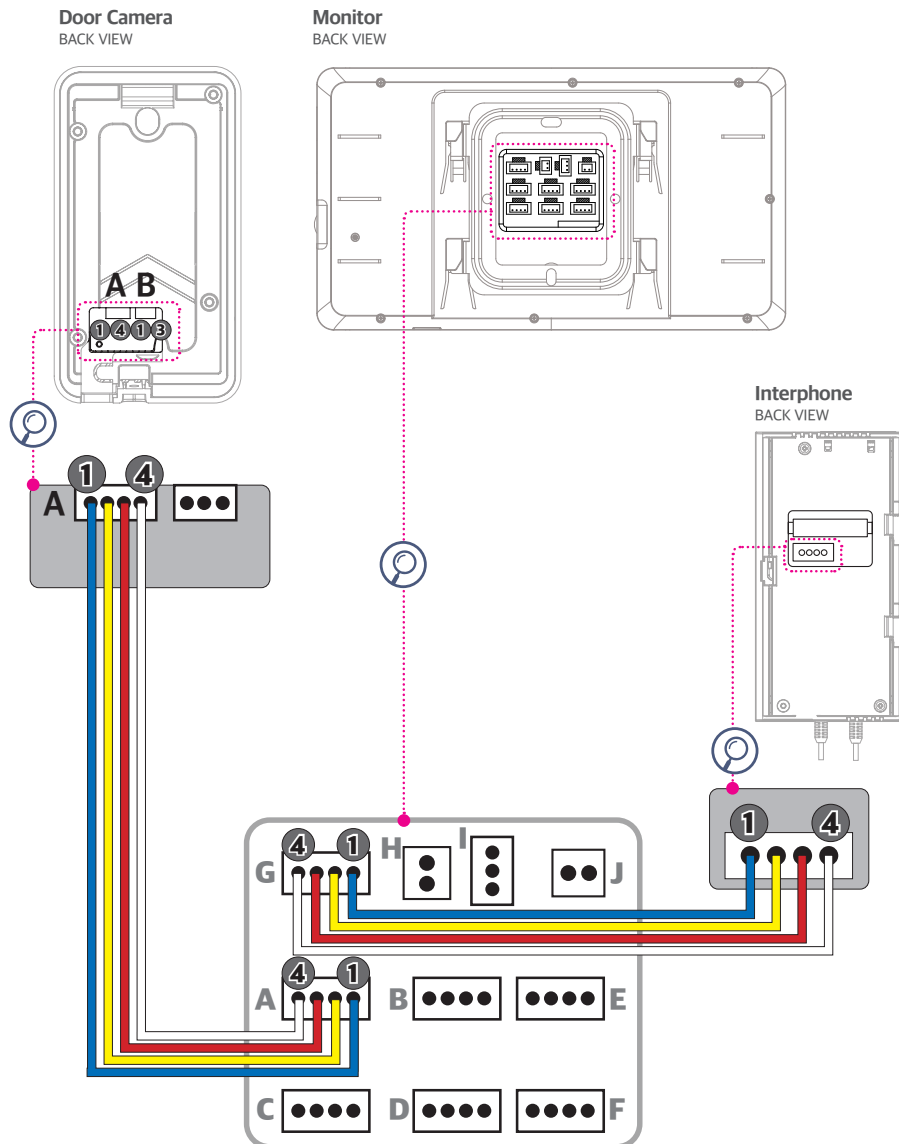

Instructions For Operation

■ Call and communication from door camera & door open

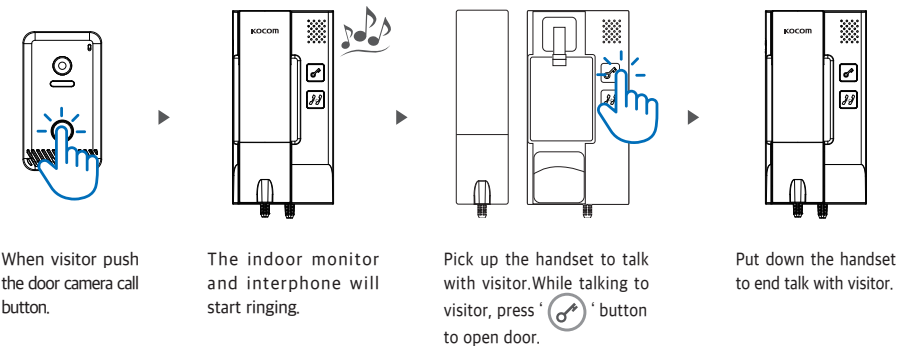

■ Internal call and communication

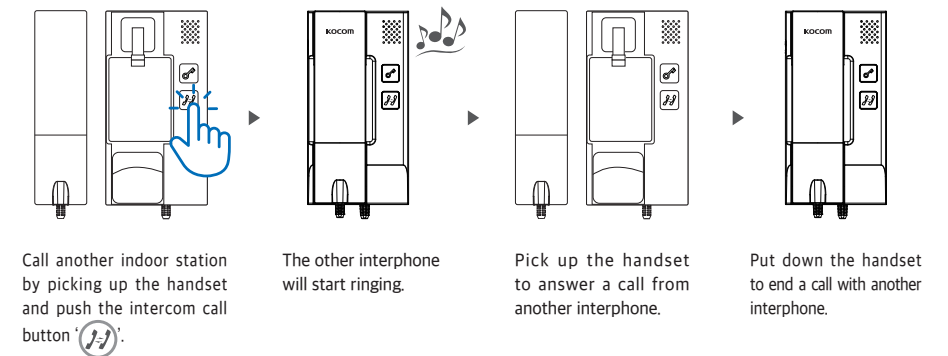

Warranty

To receive after sales service, have the following ready when you contact our branches.

1. Name of the product.
2. Model number of the product.
3. The area of problem.
4. Phone number and address at which you can be contacted.

Warranty Card

PRODUCT	
MODEL	KIP-32GU
DATE PURCHASED	
WARRANTY PERIOD	
AGENCY	
AGENCY ADDRESS	

KOCOM Warranties the original purchaser of this product as follows.

- 1) This product is produced under strict quality control and inspection procedures.
- 2) If this product breaks down during proper use as a result of product defect, KOCOM will repair it within one year from date of purchase free of charge.
- 3) The following cases will be subject to charge, even during warranty period :
 - a. Breakdown during transport, or through careless treatment, by consumer.
 - b. Breakdown caused by unauthorized repair, or system modification.
 - c. Breakdown caused by natural disaster or power disruption.