

## Name of Each Part

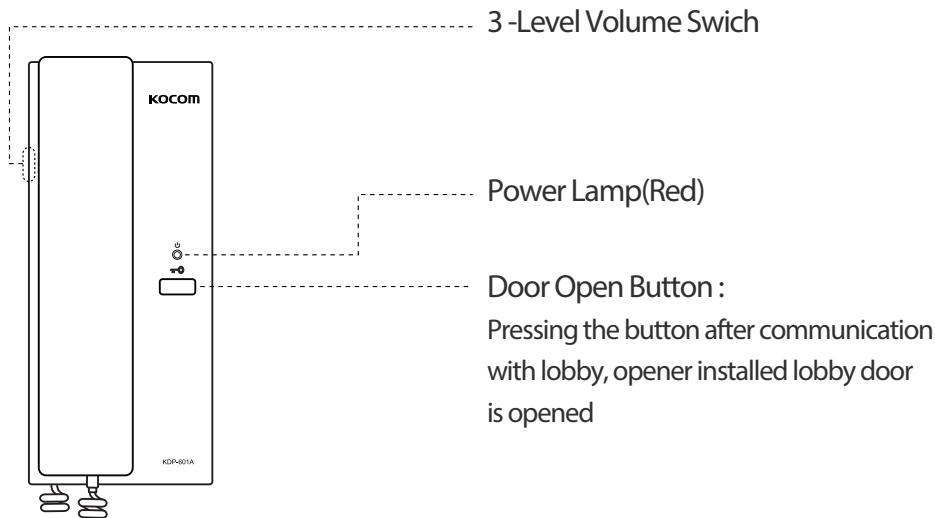

## Specifications

Model	KDP-X601Gi
Power	AC 100-240V~, 50/60Hz
Mount Type	Surface Mount
Speak Mode	Handset
Operating Temperature	0 ~ 40℃
Wiring	3 Wire x 2
Dimension	92(W) x 210(H) x 57(D) mm

## Installation

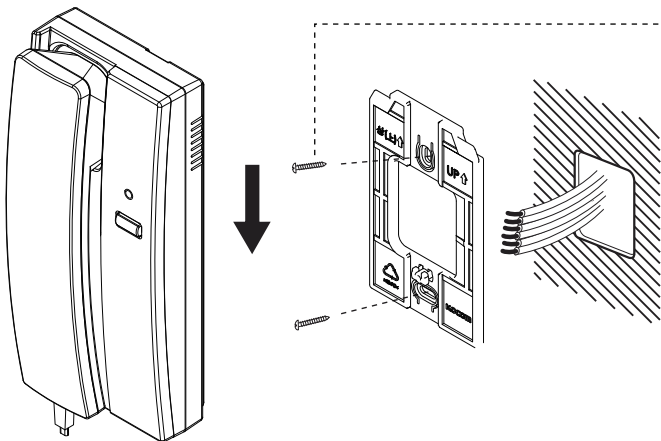

Installation screw

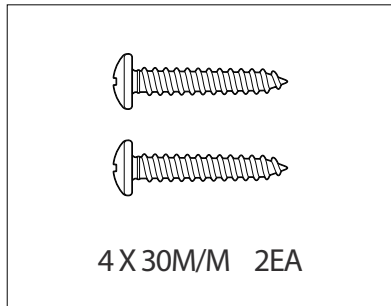

- ① Choose a place on the wall where you want to hang the DOOR PHONE.
- ② Fasten the wall hanger on the wall.
- ③ DOOR PHONE can be hung on the wall hanger easily now.



- The standard installation height of product is under 2,000mm from floor.
- The product should be installed in an easily accessible location near an electric outlet in case an emergency shutdown is needed.

View the full version of Precautions ▲



- If the unit has been dropped or physically damaged.
- If the unit exhibits a distinct change in performance.
- If the unit does not work normally by following the operating instructions.
- If liquid has been spilled into the unit.
- Unplug this unit from plug socket and refer servicing to an authorized service center when the following conditions occur:

### Cautions for Abnormality

- Do not disassemble the back and cabinet cover.
- Open the main gate after checking ID if the image and sound system do not work. Call A/S.

- Do not modify the unit.
- There may be a remote risk of an electric shock from lightning.
- During thunderstorms, avoid using this unit.
- Do not cover the ventilating opening or put any metal material in the units.
- Do not place a pot with water or a small metal material on the Units.
- Do not handle the unit with the wet hands.

### Cautions for Use

- This unit is not designed for security purpose.
- Connect the electric wire with the designed ways and ground.
- Do not distribute signal line with A/C line.
- Connect the lines after peeling the wires properly.
- Power must be connected to domestic voltage (product rated voltage) consent or interior wiring.
- Install the circuit breaker after checking the safety such as electric shock and leakage. Turn off the power before you install or A/S.
- Do not install the unit when the power is on.
- Do not use the power terminal at the units to other electric device except the designed device.
- Do not give any damage, break and modify the plug. Overloading, heating, pulling causes the damage.

### Warnings for Usage

## Warning

## Warranty

**To receive after sales service, have the following ready when you contact our branches.**

1. Name of the product.
2. Model number of the product.
3. The area of problem.
4. Phone number and address at which you can be contacted.

### Warranty Card

PRODUCT	
MODEL	
DATE PURCHASED	
WARRANTY PERIOD	
AGENCY	
AGENCY ADDRESS	

- **KOCOM** Warranties the original purchaser of this product as follows.

- 1) This product is produced under strict quality control and inspection procedures.
- 2) If this product breaks down during proper use as a result of product defect, KOCOM will repair it within one year from date of purchase free of charge.
- 3) The following cases will be subject to charge, even during warranty period :
  - a. Breakdown during transport, or through careless treatment, by consumer.
  - b. Breakdown caused by unauthorized repair, or system modification.
  - c. Breakdown caused by natural disaster or power disorder.

- ④ Unplug this device when you try to move it to another place. If there is no plug, please, turn off the circuit breaker.
- Unplug this device when you want to check the inside. If the electric line is connected inside of the unit, please contact your dealer or service center.

### Cautions for Repairs and Maintenance

- Keep the inside of the device clean. Having the dust inside without any cleaning for a long time causes the fire.
- If necessary, contact your dealer or service center to get cleaning service.
- ① Set the device of the wall-mounted type not to fall. Falling from an earthquake causes personal injury.
- Think about the thickness and quality of wall material. The unqualified material may make the device fall.
- Keep the hook at the wall-mounted device safe. The hook may cause the physical injury.
- communication disorder.
- Setting the communication lines in a high humid place such as outside without any protection from rain causes the This may result in the risk of fire, electric shock and communication disorder.
- The communication lines should be built in being distant from the power source.
- humidity due to penetration of chemicals or water into camera's urea resin.
- Beware of occurrence of image quality deterioration or malfunction from cause of
- ② Dangerous place with sprays of water or chemicals
- ③ Place with a lot of gas, dust, smoke
- ④ Place with high humidity such as bathroom, washroom, heated room
- ⑤ Place with temperature below 0℃ such as cold store
- ⑥ Place exposed to direct rays of the sun
- ⑦ Above or around water heater, rice-cooker, heater or it may cause picture distortion.
- Avoid installing near tools with strong electromagnetic waves such as microwaves and cell phones.
- Even if your product is water proof, do not install it slanted place of water leakage, which can a short circuit.
- The work from an unauthorized person cause fire or electric shock.
- The law limits distributing the power lines to an authorized person from government.

### Cautions for set-up

## Cautions

- ④ Sign to tell you that you can't disassemble this unit.
- ① Sign to tell you that you should follow the instructions.
- Mishandling the device with ignoring this sign may result physical injury or material damage.
- Sign to tell you that you need more attention including high voltages, electric shock, danger, warning)
- Sign to show what not to do

### The meaning of the drawing signs.

are used in the manual. The marks and the drawing signs are below. Please, understand the marks before reading the manual. To help our customers to understand the manual, to prevent any personal injury or property damage, some marks

### The important marks in the manual.

- If you need assistance with the set-up or operation, please contact with A/S center.
- Read and understand all instructions to set up rightly.
- Please, save this manual after reading these instructions carefully.

**Cautions for safety** For safe use, please stick to the following cautions.

# KOCOM

## DOOR PHONE

**KDP-X601Gi Manual for Operation and Installation**

- KDP-X601Gi : 100-240V~, 50/60Hz
- Compatible product : KVL-TC3XXi series
- Maximum wiring distance (UTP CAT5e) KVL-TC3XXi to last DoorPhone --100m (Resistance value of completed wiring installation: less than 10 Ohms)

KOCOM CO.,LTD.

Thank you very much for purchasing KOCOM Doorphone. please read this manual thoroughly to ensure correct usage, before operation



KOCOM CO.,LTD.

This manual is based on the date as shown in the right and specifications are subject to change without notice for quality improvement.

KDP-X601Gi	Y0627
------------	-------



# Wiring Diagram

When connecting KDP-X601Gi to KVL-TC3XXi series, the Video line of KVL-TC3XXi (pins 4, 8) is not connected.

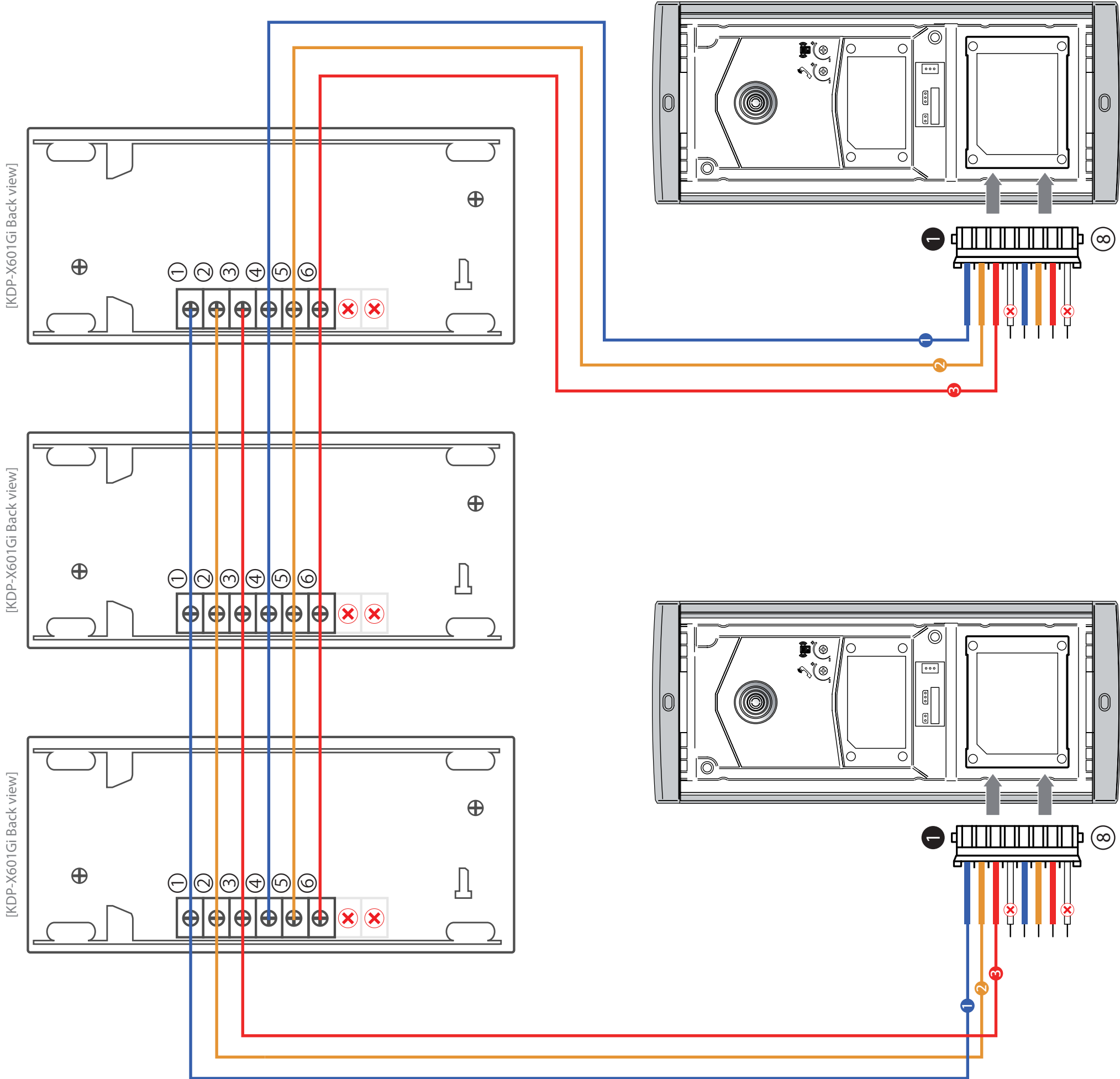

KVL-TC3XXi Series							
①	CAM VCC	①	CAM1 VCC	①	CAM1 VCC	①	CAM VCC
②	CAM GND	②	CAM1 GND	②	CAM1 GND	②	CAM GND
③	CAM Voice	③	CAM1 Voice	③	CAM1 Voice	③	CAM Voice
④	✗	④	CAM2 VCC	④	CAM2 VCC	④	✗
⑤	CAM VCC	⑤	CAM2 GND	⑤	CAM2 GND	⑤	CAM VCC
⑥	CAM GND	⑥	CAM2 Voice	⑥	CAM2 Voice	⑥	CAM GND
⑦	CAM Voice	⑦	✗	⑦	✗	⑦	CAM Voice
⑧	✗	⑧	✗	⑧	✗	⑧	✗